

Operating Manual of American-standard Lock

Please read and understand the Operating Manual before use.
Caution: Please take along an emergency key or put it in a safe place outside.

Instructions for use

- Warm tips:** Please prepare 1 cross screwdriver and drilling machine before installation.
- For the new locks just leaving the factory, if the equipment is not bound to a user, the lock can be opened by the keys of 123456+*.
 - In case of unlocking when a user has registered with the lock: Press a password of 6-10 digits +* key to unlock.
 - Please do not scratch the surface with corrosive or sharp items to prevent the lock surface from being damaged.
 - When the battery is running low or the electric part is out of order, an emergency key can be used to unlock outside, please take good care of the key and keep it in a safe place outdoors.
 - After assembly, the door must be kept in an open state so as to conduct commissioning and initialized parameter setting.
 - Operating temperature: -4°F/-20°C+158°F/+70°C.

Packing list

S/N	Content	Quantity
1	Key	1
2	User manual	1
3	Hanging lanyard	1
4	USB charging cable	1
5	Black Pearl Sponge Cover	2

Product Overview

Smart Safe Box Product Introduction

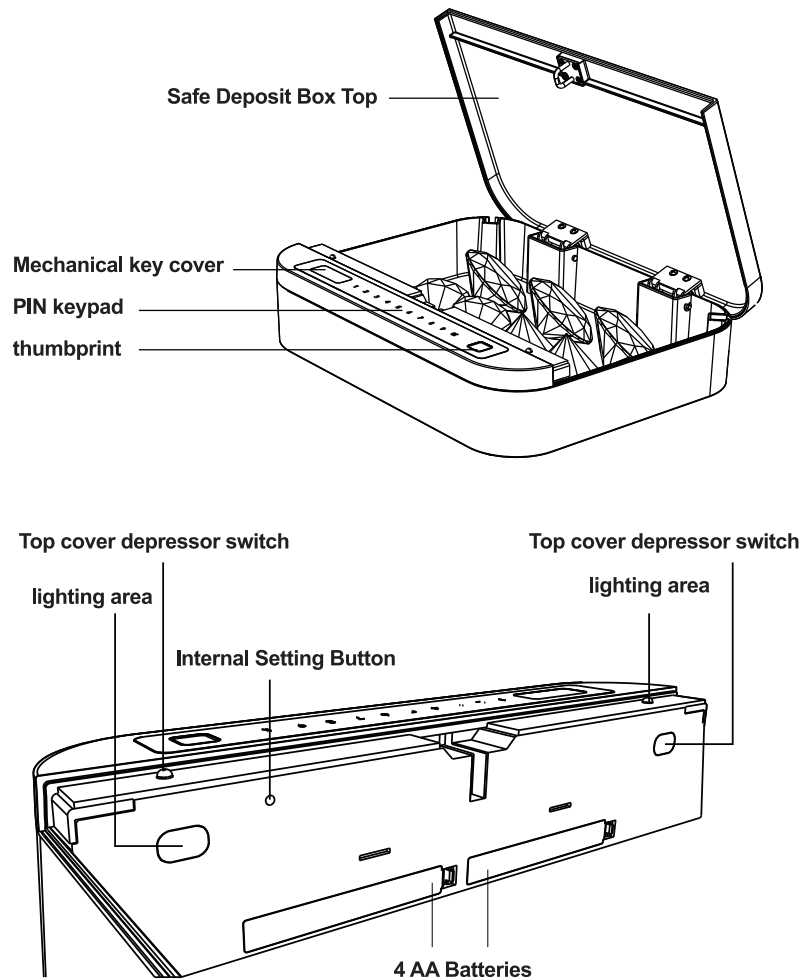

Product specification and how to operate the menu

Name	Content
Operating Voltage	6V DC (4 alkaline batteries)
Maximum Current	≤180mA
Supports Bluetooth	Tuya Bluetooth
Unlock Mode	Fingerprint, password, mobile app, and mechanical key unlocking
Number of passwords	50 sets of passwords (password length: 6-10 characters)
Fingerprint Capacity	50 fingerprints
Unlock Logs	Local Storage of 100 Records
Anti-static Capability	The IEC 61000-4-2 standard 8-15KV
Operating Temperature Range	-20°C - +70°C
Low Voltage Alarm	<4.8V
Operating humidity	0-95%

Lock Status Indication

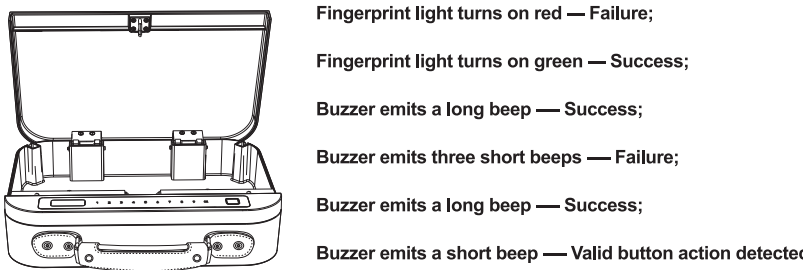

Operating process

Fingerprint Recognition Button

In fingerprint verification, press your finger as shown in the image. Once the fingerprint is successfully verified, the fingerprint indicator light will turn green, and the lock will be able to open. After 5 seconds, it will automatically lock again. When the recognition fails, the fingerprint indicator light will turn red.

Correct finger placement for recognition:

Place your finger flat and gently on the fingerprint sensor as shown in the image. Make sure that the center of your finger aligns with the center of the fingerprint scanner.

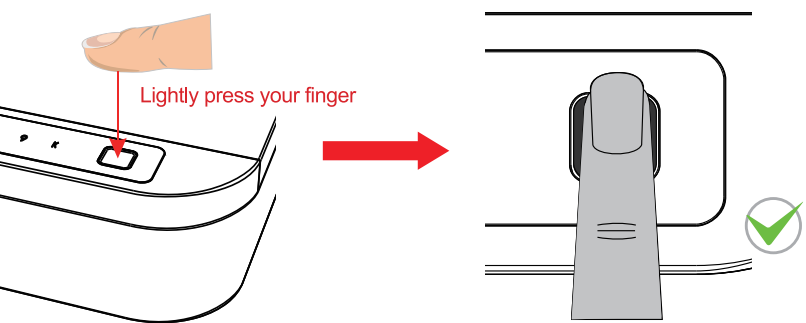

Incorrect fingerprint recognition method:

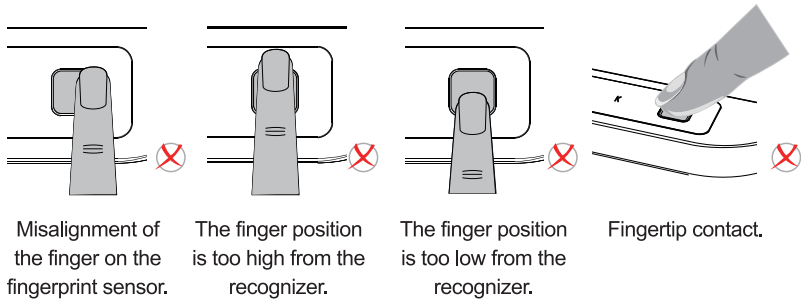

Unlocking Method

Password Recognition Unlocking

When in the default state, enter a 6-10 digit password and press the OK button to confirm. After successful password verification, the fingerprint indicator light will turn green, and the lock will be unlocked. The lock will automatically re-lock after 5 seconds. (When you first receive the lock, there are no registered users. At this point, you can open the lock by entering "123456+OK," which enters the experience mode. Once you register fingerprints or passwords, only the registered passwords or fingerprints can be used to unlock the lock). When recognition fails, the fingerprint indicator light will turn red.

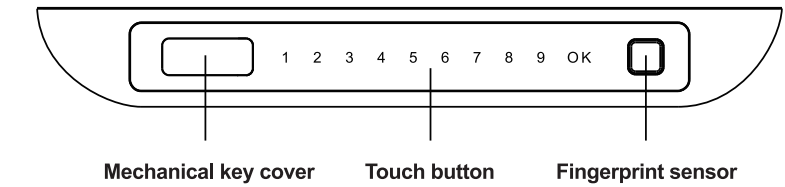

Unlocking with a mechanical key

This box is equipped with a mechanical key (C-level security) for unlocking. In case the electronic components fail to unlock, you can use the mechanical key to open the box.

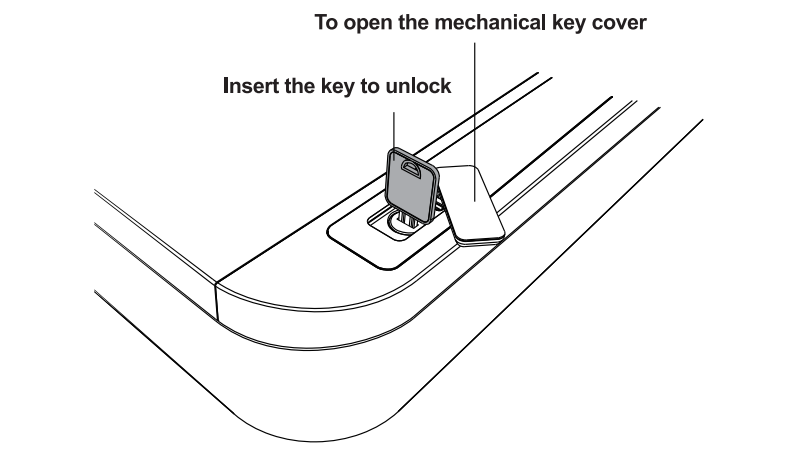

System initialization

Long press the internal settings button for about 8 seconds, and you will hear a beep (you can release the button now). The system initialization is successful, and all passwords and fingerprint data for users are cleared. The system is restored to its factory default settings. Please note that after performing the factory reset, all passwords and fingerprint user data will be cleared, rendering the previously registered fingerprints invalid. Only the default password "123456" will continue to work for unlocking. When you add new users, the previous default password "123456" will no longer be valid, and only the fingerprints or passwords of the newly added users can be used for unlocking.

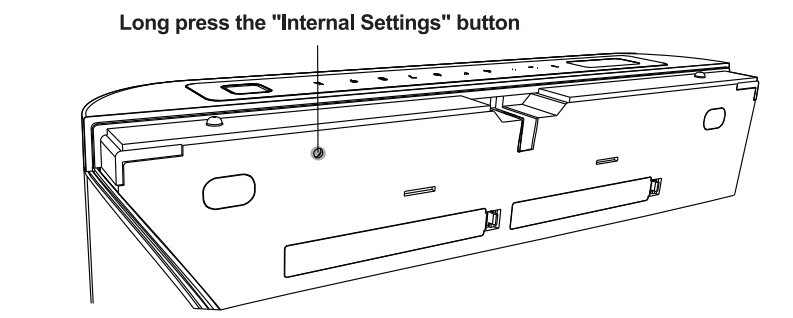

To register a fingerprint user:

Press the "Internal Settings" button (hold for 3 to 6 seconds and then release it) once. The fingerprint indicator light will start blinking. Within the next 20 seconds, place your finger on the fingerprint sensor and press it down five times. You will hear a long beep sound, and the fingerprint indicator light will stay solid green, indicating successful registration for that user. If you want to register another user, repeat the above steps.

To register a password user:

Press the "Internal Settings" button (hold for 3 to 6 seconds and then release it). The fingerprint indicator light will start blinking. Within the next 20 seconds, begin entering a 6-10 digit password using the keypad or input method provided by the device. After entering the password, press the "OK" button. Then, enter the same password again to confirm it. You will hear a long beep sound, and the fingerprint indicator light will stay solid green, indicating successful registration for that user. If you want to register another user, repeat the above steps for each additional user.

Tuya Smart APP Instructions

- Download the App**
Download Tuya App from the App Store (iOS devices) or Google Play (Android devices)
- Sign up the account**
Create your account and follow the set up instructions in the Tuya app

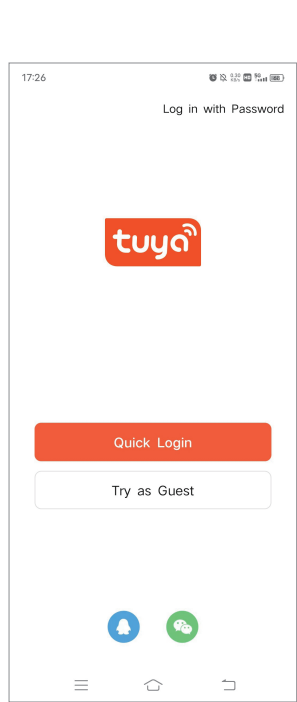

Tuya Smart APP Instructions

3 Add the device to your APP

- Before using the App for network configuration, the safe must have at least one password added.
- Press the internal settings button (hold for 3 to 6 seconds and then release), the fingerprint indicator light will flash green. At this point, the safe enters the network configuration mode (it will automatically exit after 120 seconds of inactivity).

Note:
1. Once the safe is connected to the phone, you need to reset it to factory settings before you can enter the pairing mode again.

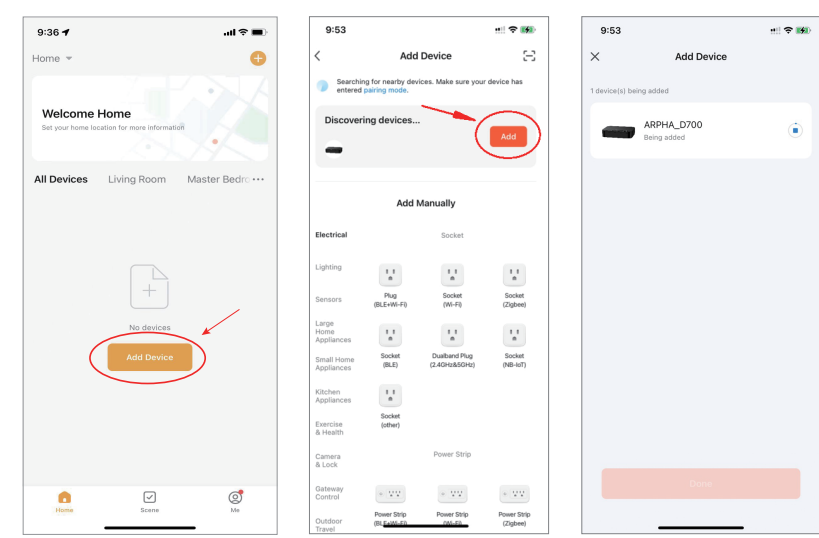

Tuya Smart APP Instructions

Manually add devices
Path: + in the upper right corner of the mobile phone - Add Device - Camera & Lock - Safe Box (BLE)

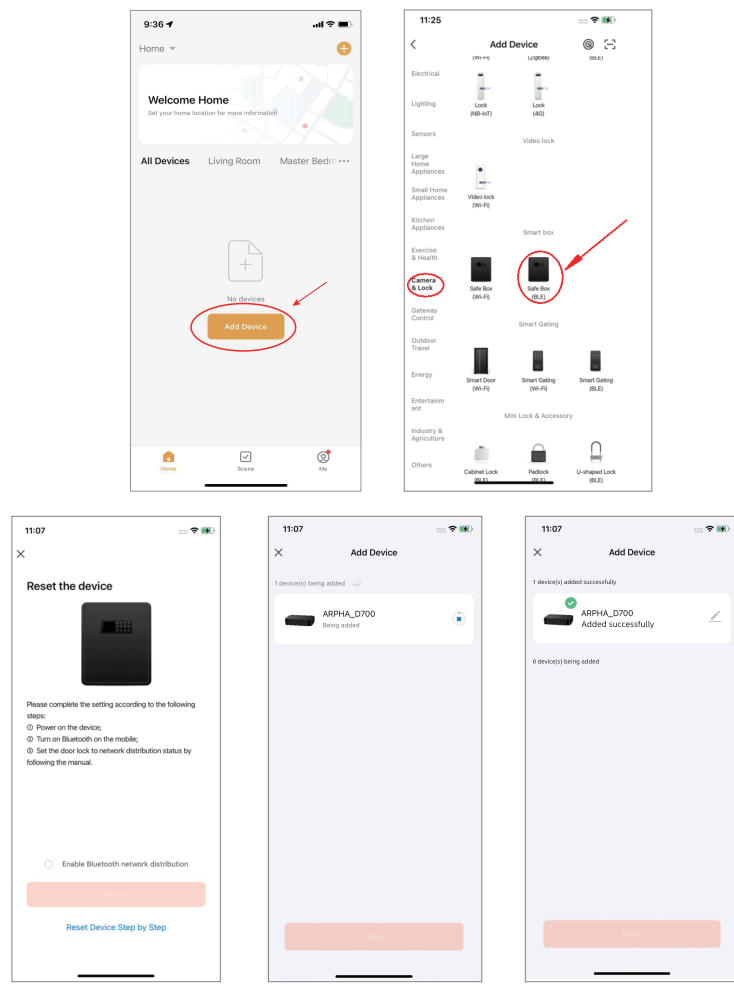

Tuya Smart APP Instructions

4 APP unlock

Open the APP and the following interface appears, press and hold the unlock button below to unlock.

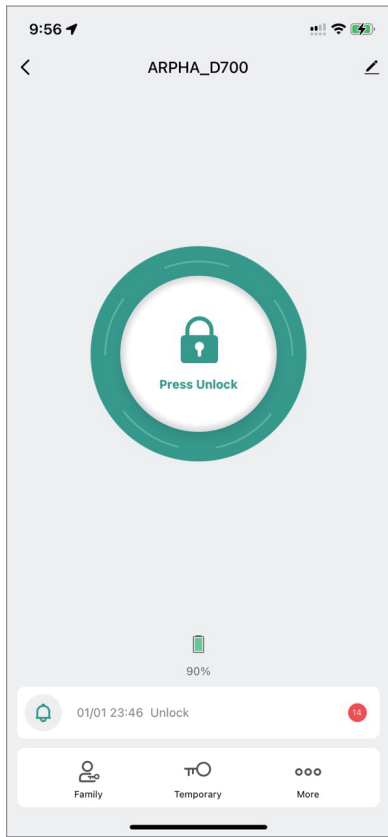

Tuya Smart APP Instructions

5 APP add password

Open the APP and the following interface appears, add the lock password.

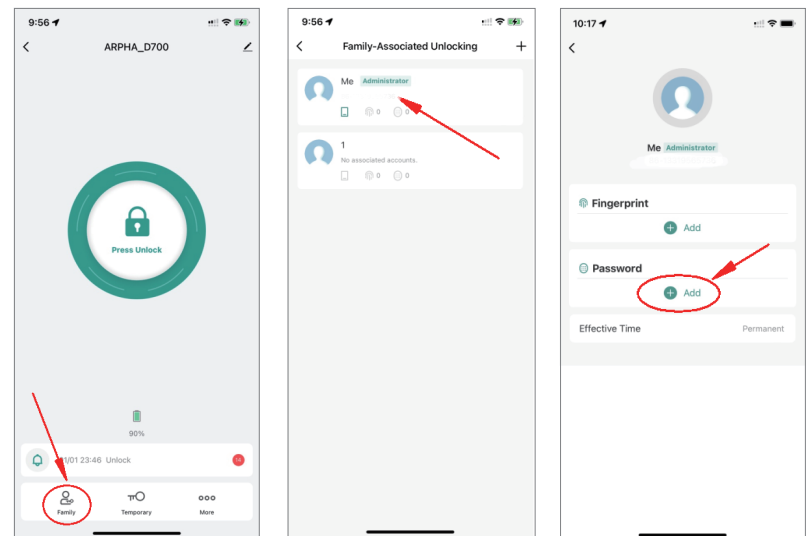

Tuya Smart APP Instructions

6 APP check unlock record

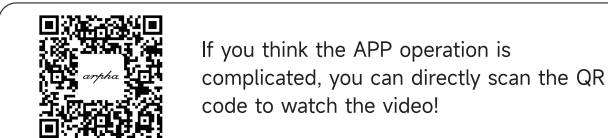
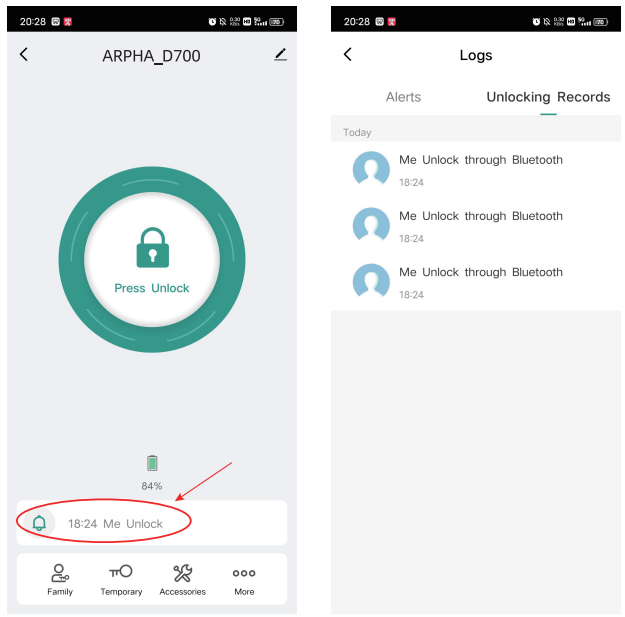

If you think the APP operation is complicated, you can directly scan the QR code to watch the video!

Tuya Smart APP Instructions

7 Adding Fingerprint:

When you open the app, you will see the following interface. Enter the "Add Fingerprint" section and follow the steps in the image below to complete the fingerprint enrollment process.

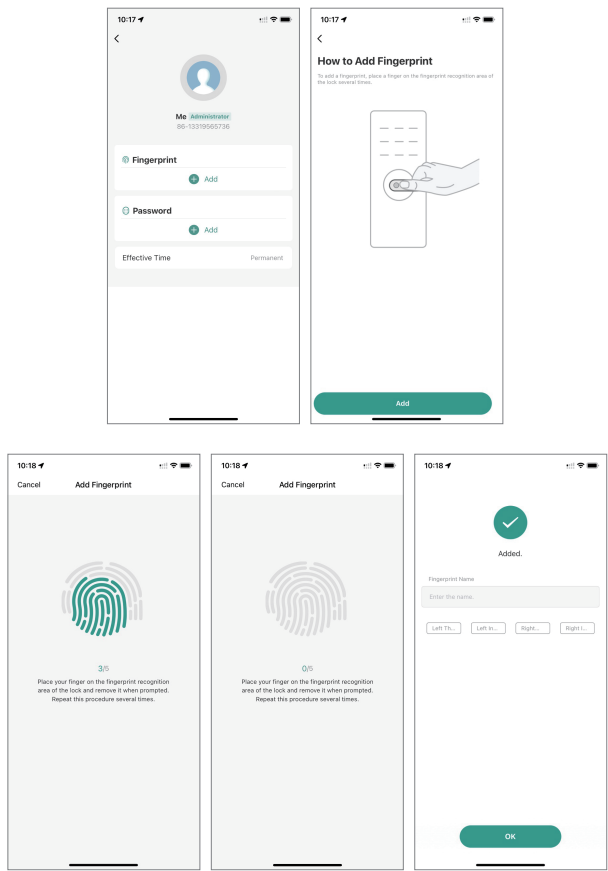

Low battery voltage alarm

When the low battery voltage alarm is triggered before opening the door, the device will exhibit the following behavior: the indicator light will flash rapidly in red, and the buzzer will sound a fast alarm, as shown in the figure. To resolve this, open the battery cover and replace the batteries with new ones.

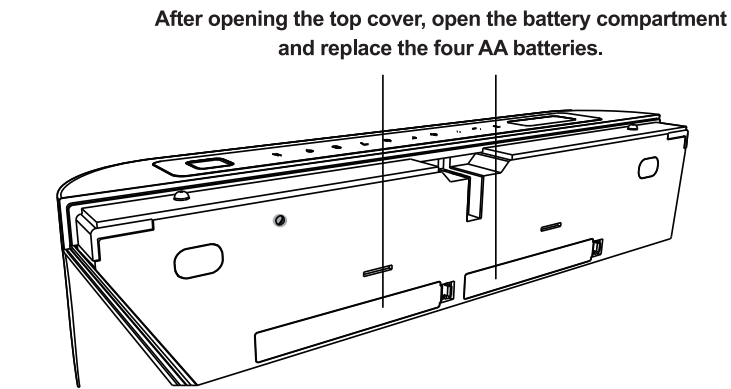

- The batteries used should be alkaline batteries of size AA (5). Check the manufacturing date on the batteries and avoid using batteries that are more than one year old.
- Always replace all four batteries at the same time.
- Pay close attention to the correct polarity and ensure the positive (+) and negative (-) ends are placed correctly while inserting the batteries.

Unlocking using USB backup power

When the batteries are depleted, you can use an external USB power source, such as a power bank, through the USB port to temporarily unlock the lock. Please ensure that the USB power source provides a 5V power output. After unlocking, make sure to immediately replace the depleted batteries with new ones (all four batteries together). This will ensure proper functioning and avoid any inconvenience in the future.

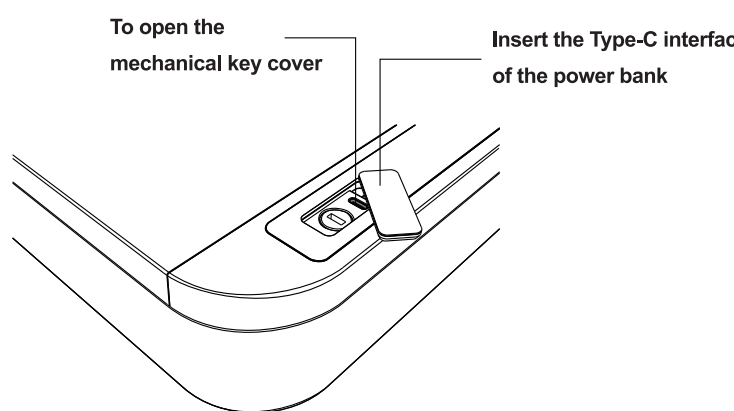

Usage precautions

- This device is battery-powered. It is essential to install four batteries first.
 - If the device continues to have recognition failures, please confirm whether the user's fingerprint or password has been registered correctly. If necessary, re-register the user.
 - Before use, check whether the batteries are correctly installed to ensure the device is powered on.
- Note:** The translation may vary slightly based on the context and product specifications.

D700说明书

材质: 105克铜版纸, 四色印刷, 骑马订

展开尺寸: 240x170mm(成型尺寸120x170mm)